

# VitrA

---

Description Rapid Installation - For Wall-Hung Wc Pans? Drywall Application Set

---

Code 742-5800-01

Installation Type Rapid Installation (Front Wall: Light Weight Construction-Gypsumplate, Back Wall: Brick)

Working Pressure 0,5-10 Bar (Recommended 3-5 Bar)

WC Type Wall Hung WC Pans

Control System Electronic and Mechanic Control

Water Capacity 3-6 L(Adjustable)



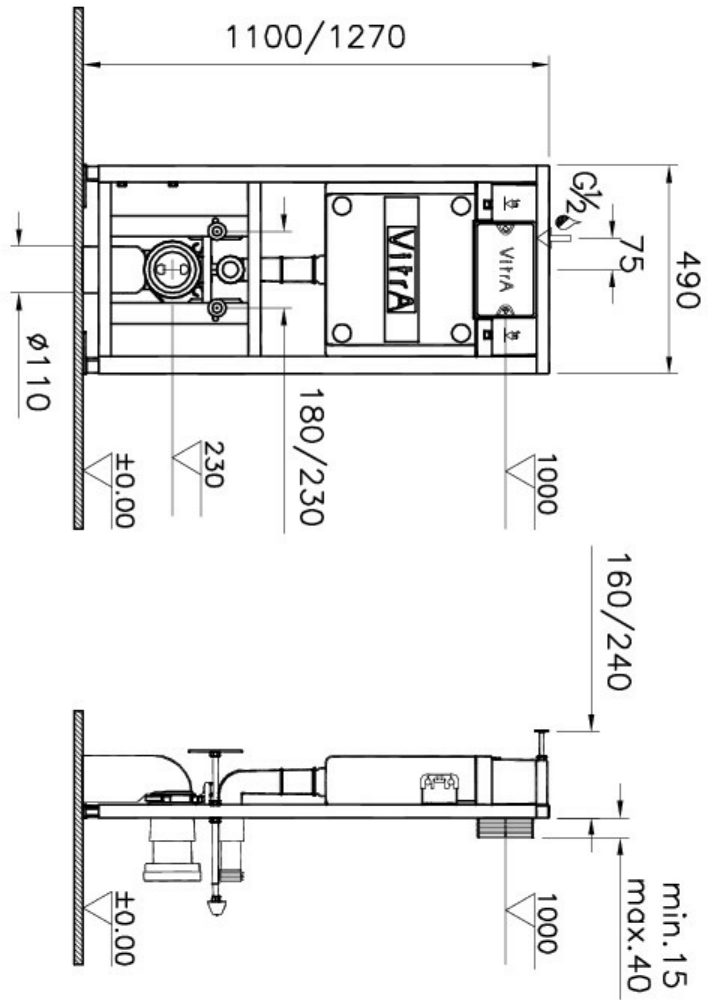

Vitra retains the right to change details about the products and technical specifications without prior notice.